

# 557.50



EN 71

ASTM F963



- DK** Reservedele
- GB** Spare Parts
- DE** Ersatzteile

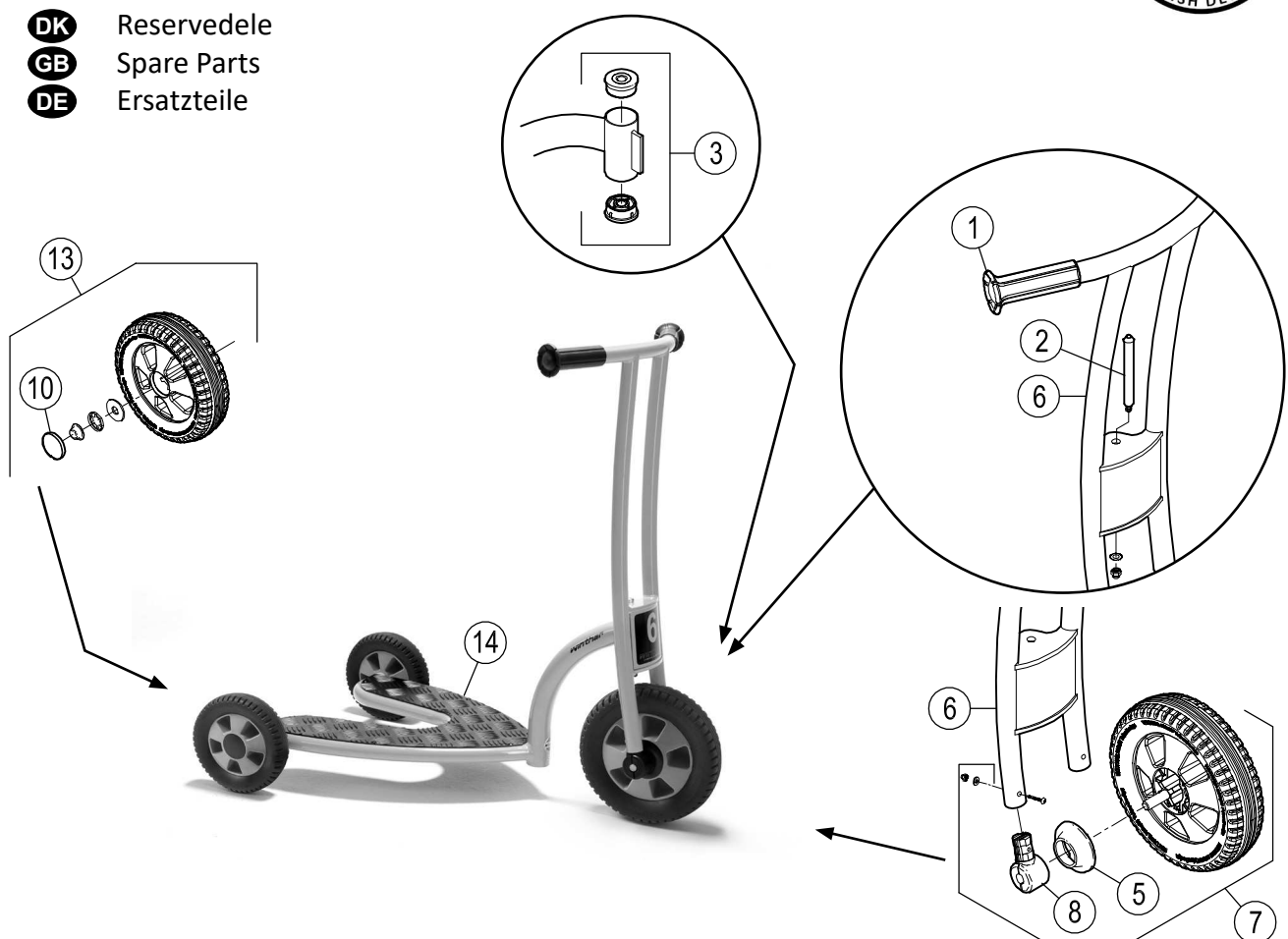

Pos.		Pos.	
1	x2  x2	8	x2  x2  x1
2	x1  x2  x1  x1  x1	9	
3	x2	10	x2
4		11	
5	x2	12	
6		13	
7		14	

# 557.50



EN 71

ASTM F963



- DK** Reservedele
- GB** Spare Parts
- DE** Ersatzteile

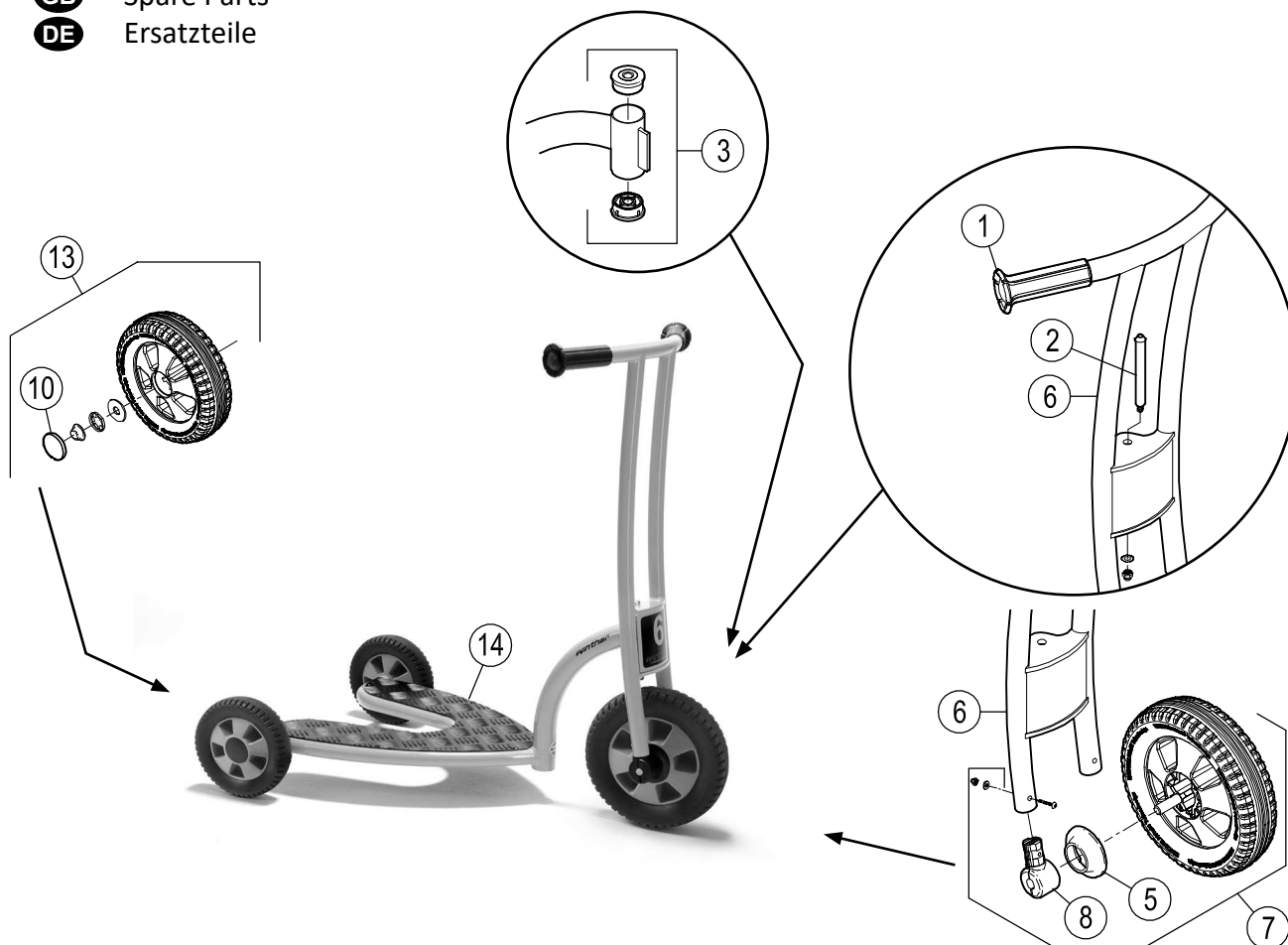

557.50		Version	
Pos.	1.0	1.1	
1	8850403	8850403	
2	7650401	7650401	
3	7650404	7650404	
4	-	-	
5	7650270	7650270	
6	7650454	7650454	
7	7650280	7650280	
8	7650406	7650406	
9	-	-	
10	7650284	7650284	
11	-	-	
12	-	-	
13	7650297	7650297	
14	7650487	7650487	
15	-	-	

